



* No Onward Chain * Spacious three-bedroom semi-detached home offering generous living accommodation, a large rear garden with an outbuilding, and a convenient Southend-on-Sea location close to schools and transport links.

- Three Bedroom Semi-Detached House with No Onward Chain
- Good-Sized Kitchen with space for a Breakfast Table
- Three Generous Bedrooms
- Generous Rear Garden with Outbuilding
- Double Glazing
- Bay Fronted Lounge/Diner with a Fireplace
- Ground Floor Three Piece Shower Room
- Convenient First Floor Two Piece WC
- Ample Living Space Throughout
- Gas Central Heating

Maldon Road

Southend-on-Sea

£300,000



Maldon Road



This well-proportioned semi-detached house is ideal for families, providing ample living space throughout. The property opens with an entrance hall leading into a bay-fronted lounge/diner, complete with a feature fireplace and access to the rear. A good-sized kitchen offers space for a breakfast table, while an inner lobby provides further access to the garden and leads to a three-piece shower room. To the first floor, the landing gives access to a large double bedroom, along with two further generously sized bedrooms and a two-piece WC. Externally, the home benefits from a generous rear garden with an outbuilding, ideal for storage or potential workspace. Additional advantages include double glazing and gas central heating.

Situated on Maldon Road in Southend-on-Sea, the property falls within the catchment area for Bournemouth Park Academy and Cecil Jones Academy. The location provides easy access to a range of local amenities, parks, and bus links. Both Southend East and Prittlewell Train Stations are within easy reach, along with the city centre, making this a convenient setting for commuters and families alike.

Three Bedroom Semi-Detached House

Entrance Hall

20'8 x 5'3 > 3'2

Lounge/Diner

25'2 x 11'2 > 9'3

Kitchen

11'1 x 10'4

Inner Lobby

Three Piece Shower Room

10'6 > 3'10 x 6'8

Landing

Bedroom One

15'0 x 10'10

Bedroom Two

11'7 x 9'4

Bedroom Three

10'7 x 7'1

WC

7'5 x 2'10

Garden



Floor Plan

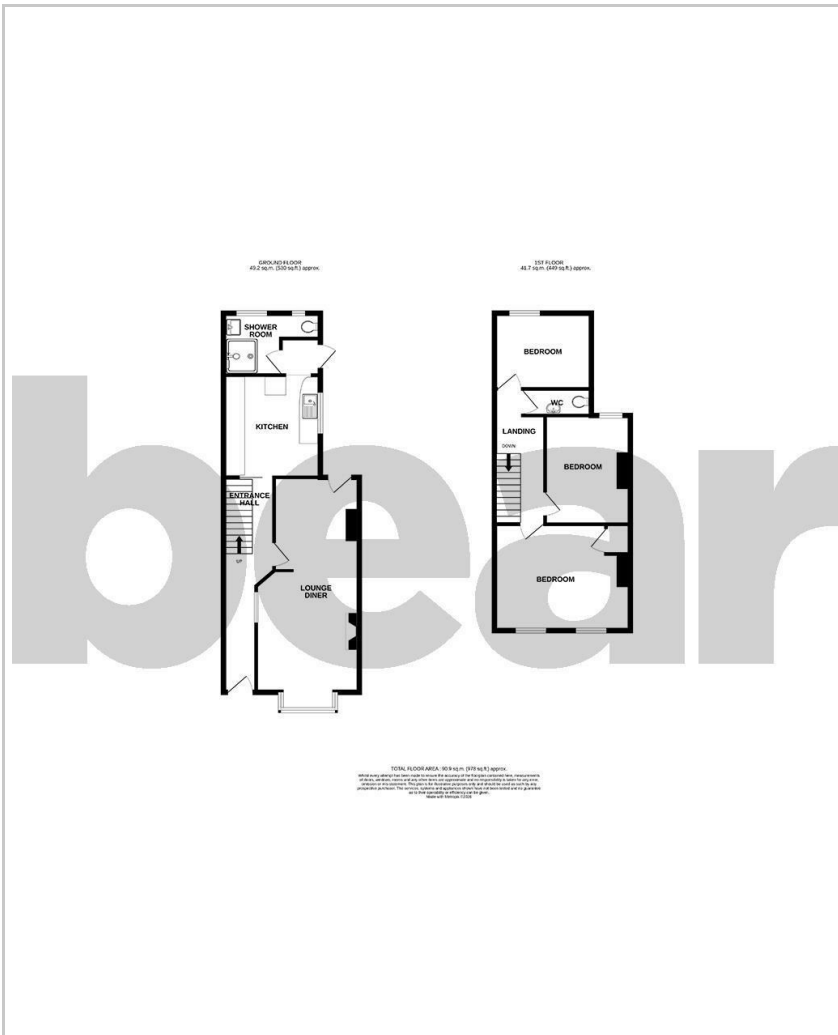

Area Map

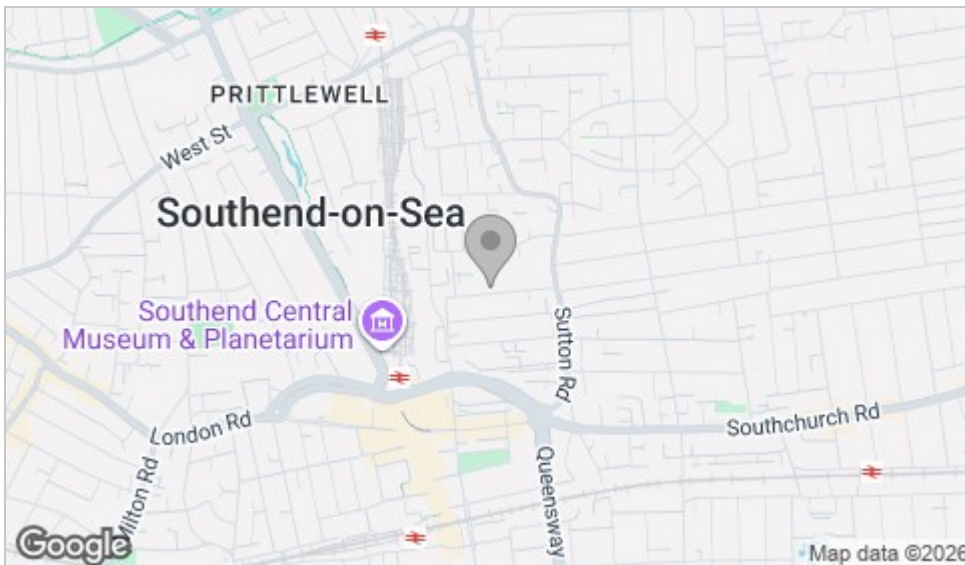

Viewing

Please contact our Southend-on-Sea Office on 01702 811211 if you wish to arrange a viewing appointment for this property or require further information.

These particulars, whilst believed to be accurate are set out as a general outline only for guidance and do not constitute any part of an offer or contract. Intending purchasers should not rely on them as statements of representation of fact, but must satisfy themselves by inspection or otherwise as to their accuracy. No person in this firm's employment has the authority to make or give any representation or warranty in respect of the property.

204 Woodgrange Drive, Southend-on-Sea, Essex, SS1 2SJ

Office: 01702 811211 info@bearestateagents.co.uk <https://www.bearestateagents.co.uk>

Energy Efficiency Graph

